



**HESS**  
AUCTION GROUP

**Public Auction**  
**REAL ESTATE**

# WELL-LOCATED 3 BEDROOM TOWNHOUSE



**Tues. October 19, 2021 • 6PM**

**1749 BETZ FARM DR.  
LANCASTER, PA 17603**

**T**his 3-bedroom, end unit townhouse is nestled in a great neighborhood and offers easy access to main roads. The **first floor of the home** features an eat-in kitchen, dining room, living room, and powder room. The **second floor** boasts 3 bedrooms and a full bath, with one bedroom having access to the full bath. The **basement** is unfinished and hosts the laundry and mechanicals. **Additional amenities** include an attached, 1-car garage.

**AUCTIONEER'S NOTE:**

**Open Houses: Sat. Oct. 9, 10am – 12pm  
& Mon. Oct. 11, 5pm – 6:30pm  
Or Call For An Appointment**

Auction for: Deborah A. Pipkin Estate  
Attorney: Blakinger Thomas

\*For information about financing call 717-664-5238\*

**Real Estate Terms & Conditions:** 10% down day of sale. Balance due at settlement on or before 45 days. Announcements made on day of sale take precedence over advertised information.

JOHN M. HESS AUCTION SERVICE 717-664-5238 or 877-599-8894 HESSAUCTIONGROUP.COM  
AY000253L



**Type:** End-Unit Townhouse  
**Construction:** Frame  
**Exterior:** Vinyl Siding  
**Roof:** Shingle  
**Garage:** Attached 1-Car, Door Opener  
**Square Footage:** 1,356sq. ft.  
**Lot Size:** 0.10 acres  
**Year Built:** 1992

**Heating/Cooling:** Electric Heat Pump Forced Air/Central  
**Water/Sewer:** Public, Electric Water Heater, Water Conditioning System  
**Electric:** 200amp  
**Zoning:** Residential  
**Taxes:** \$3,159 (2019)  
**School District:** McCaskey SD  
**Township:** Lancaster Township

## **First Floor**

---

**Entry:** Stairs, Garage Entrance, Hardwood  
**Living Room:** 12'10" x 12'7", Carpet  
**Dining Room:** 12'10" x 10'8", Patio Door, Carpet  
**Kitchen:** 12'1" x 12'10", Microwave, Dishwasher, Disposal, Hall Pantry, Patio Door, Vinyl  
**Half Bath:** 3' x 6'9", Hardwood

## **Second Floor**

---

**Bedroom 1:** 16'6" x 11'6", Vaulted Ceiling, Ceiling Fan, Walk-in Closet, Private Bath Access  
**Bedroom 2:** 11'3" x 10'5", Closet, Carpet  
**Bedroom 3:** 12' x 8'3", Closet, Carpet  
**Bath:** 11'6" x 6'3", Tub/Shower Combination, Linen, Skylight, Vinyl

## **Lower Level**

---

22'9" x 25, Partially Finished, Laundry Hook-up, Laundry Tub, Sump Pump, Carpet

## **Exterior**

---

Covered Front Porch, Rear Wood Deck

**\*All Measurements are Approximate\***

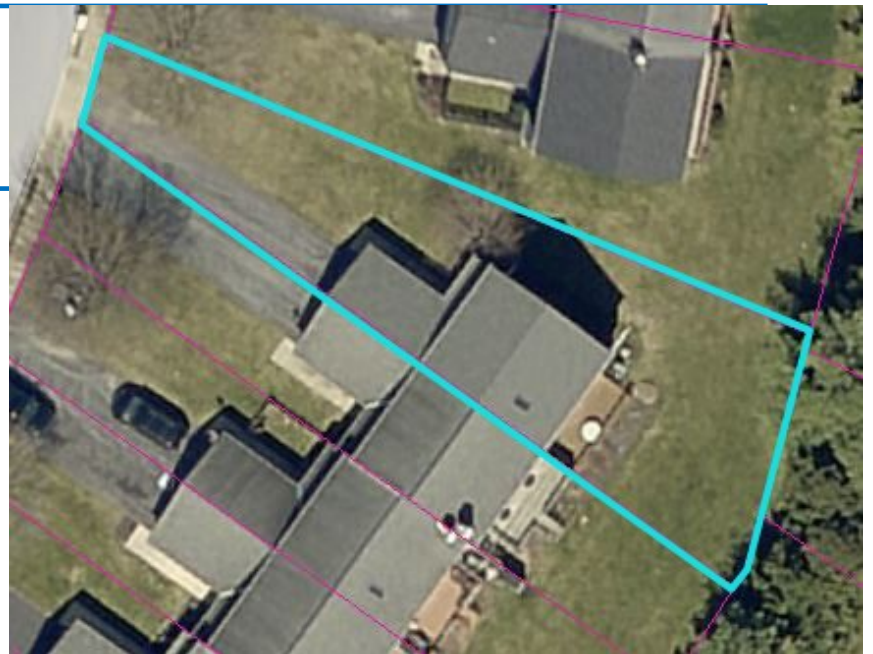

## **LENDERS**

**Chris Karshin**  
Fulton Bank  
717-682-0693  
CKarshin@fultonmortgag  
ecompany.com

**Dwight Rohrer**  
Bank of Bird-In-Hand  
717-572-1492  
drohrer@bihbank.com

**Megan Livengood**  
Bank of Bird-In-Hand  
717-929-2208  
mliven-  
good@bihbank.com

**Marvin Charles**  
MidAtlantic Farm Credit  
717-368-7387  
mcharles@mafc.com

**Dale Hershey**  
Univest  
717-519-7077  
hersheyd@univest.net

**Jason R. Landis**  
First Citizens Community  
Bank  
717-575-7435  
jrlandis@myfccb.com

This fact sheet is provided as a courtesy. Information included is believed to be accurate & has been provided to us by the consignor. John M. Hess Auction Service is not responsible for any clerical errors or misrepresentations by consignor in above printed materials. The purchaser is responsible to research and verify any and all information regarding this property.